

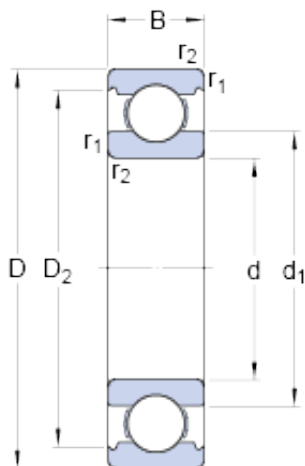

BEARING MFG. CORP.

Motorcycle Parts SKF Deep Groove Ball Bearing 6309

Bearing No. 6309



6309 Bearing 2D drawings and 3D CAD models

Size	100x45x25 mm
Bore Diameter	100 mm
Outer Diameter	45 mm
Width	25 mm
d	45 mm
D	100 mm
B	25 mm
d ₁	62.18 mm
D ₂	86.7 mm
r _{1,2} - min.	1.5 mm
d _a - min.	54 mm
D _a - max.	91 mm
r _a - max.	1.5 mm
Basic dynamic load rating - C	55.3 kN
Basic static load rating - C ₀	31.5 kN
Fatigue load limit - P _u	1.3 kN
Reference speed	15000 r/min
Limiting speed	9500 r/min
Calculation factor - k _r	0.03
Calculation factor - f ₀	13
Category	Single Row Ball Bearings
Inventory	3.0
Manufacturer Name	SKF
Minimum Buy Quantity	N/A



BEARING MFG. CORP.

Weight / Kilogram	0.83
EAN	7316577062000
Product Group	B00308
Enclosure	Open
Precision Class	ABEC 1 ISO P0
Maximum Capacity / Filling Slot	No
Rolling Element	Ball Bearing
Snap Ring	No
Internal Special Features	No
Cage Material	Steel
Internal Clearance	C0-Medium
Inch - Metric	Metric
Long Description	45MM Bore; 100MM Outside Diameter; 25MM Outer Race Diameter; Open; Ball Bearing; ABEC 1 ISO P0; No Filling Slot; No Snap Ring; No Internal Special Features
Category	Single Row Ball Bearing
UNSPSC	31171504
Harmonized Tariff Code	8482.10.50.68
Noun	Bearing
Keyword String	Ball
Manufacturer URL	http://www.skf.com
Manufacturer Item Number	6309
Weight / LBS	1.83
Outside Diameter	3.937 Inch 100 Millimeter
Outer Race Width	0.984 Inch 25 Millimeter
Bore	1.772 Inch 45 Millimeter
d ₁	62.18 mm
D ₂	86.7 mm
r _{1,2} min.	1.5 mm



BEARING MFG.CORP.

d_a min.	54 mm
D_a max.	91 mm
r_a max.	1.5 mm
Basic dynamic load rating C	55.3 kN
Basic static load rating C_0	31.5 kN
Fatigue load limit P_u	1.34 kN
Calculation factor k_r	0.03
Calculation factor f_0	13
Mass bearing	0.83 kg