

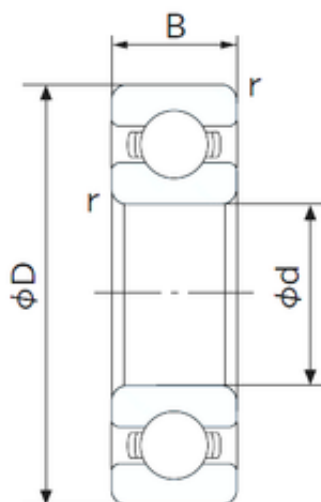

BEARING MFG. CORP.



6006 2RS Distributor of SKF NSK NTN NACHI Koyo Timken Deep Groove Ball Bearing

Bearing No. 6006

| | |
|-------------------------------|------------------|
| Size | 30x55x13 mm |
| Bore Diameter | 30 mm |
| Outer Diameter | 55 mm |
| Width | 13 mm |
| d | 30 mm |
| D | 55 mm |
| B | 13 mm |
| C | 13 mm |
| r min. | 1 mm |
| da min. | 35 mm |
| Da max. | 50 mm |
| ra max. | 1.0 mm |
| Weight | 0.117 Kg |
| Basic dynamic load rating (C) | 13,2 kN |
| Basic static load rating (C0) | 8,3 kN |
| (Grease) Lubrication Speed | 12000 r/min |
| Enclosure | Open |
| Bore Type | Cylindrical Bore |
| Configuration | Single Row |
| Bore Size | 30 mm |
| Outside Diameter | 55 mm |
| Width | 13 mm |
| Fillet Radius/Chamfer | 1 mm |
| Dynamic Load Rating | 13,200 N |
| Static Load Rating | 8,300 N |

6006 Bearing 2D drawings and 3D CAD models



BEARING MFG.CORP.

| | |
|-------------------------|-------------------|
| Limiting Speed - Grease | 13,000 rpm |
| Limiting Speed - Oil | 15,000 rpm |
| Factor f_0 | 14.8 |
| Radial Clearance | 0.005 to 0.020 mm |
| d_a (min) | 35 mm |
| D_a (max) | 50 mm |
| r_a (max) | 1 mm |