

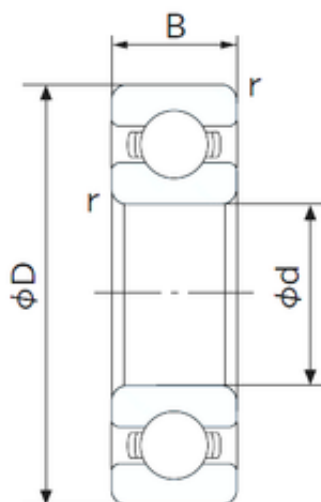

BEARING MFG. CORP.



6006 2RS 6006zz Z1V1 Z2V2 Z3V3 ISO Deep Groove Ball Bearing SKF NSK NTN NACHI Koyo OEM

Bearing No. 6006

Size	30x55x13 mm
Bore Diameter	30 mm
Outer Diameter	55 mm
Width	13 mm
d	30 mm
D	55 mm
B	13 mm
C	13 mm
r min.	1 mm
da min.	35 mm
Da max.	50 mm
ra max.	1.0 mm
Weight	0.117 Kg
Basic dynamic load rating (C)	13,2 kN
Basic static load rating (C0)	8,3 kN
(Grease) Lubrication Speed	12000 r/min
Enclosure	Open
Bore Type	Cylindrical Bore
Configuration	Single Row
Bore Size	30 mm
Outside Diameter	55 mm
Width	13 mm
Fillet Radius/Chamfer	1 mm
Dynamic Load Rating	13,200 N

6006 Bearing 2D drawings and 3D CAD models



BEARING MFG.CORP.

Static Load Rating	8,300 N
Limiting Speed - Grease	13,000 rpm
Limiting Speed - Oil	15,000 rpm
Factor f_0	14.8
Radial Clearance	0.005 to 0.020 mm
d_a (min)	35 mm
D_a (max)	50 mm
r_a (max)	1 mm